

The Honeycut Tract

Louisiana, AC +/-

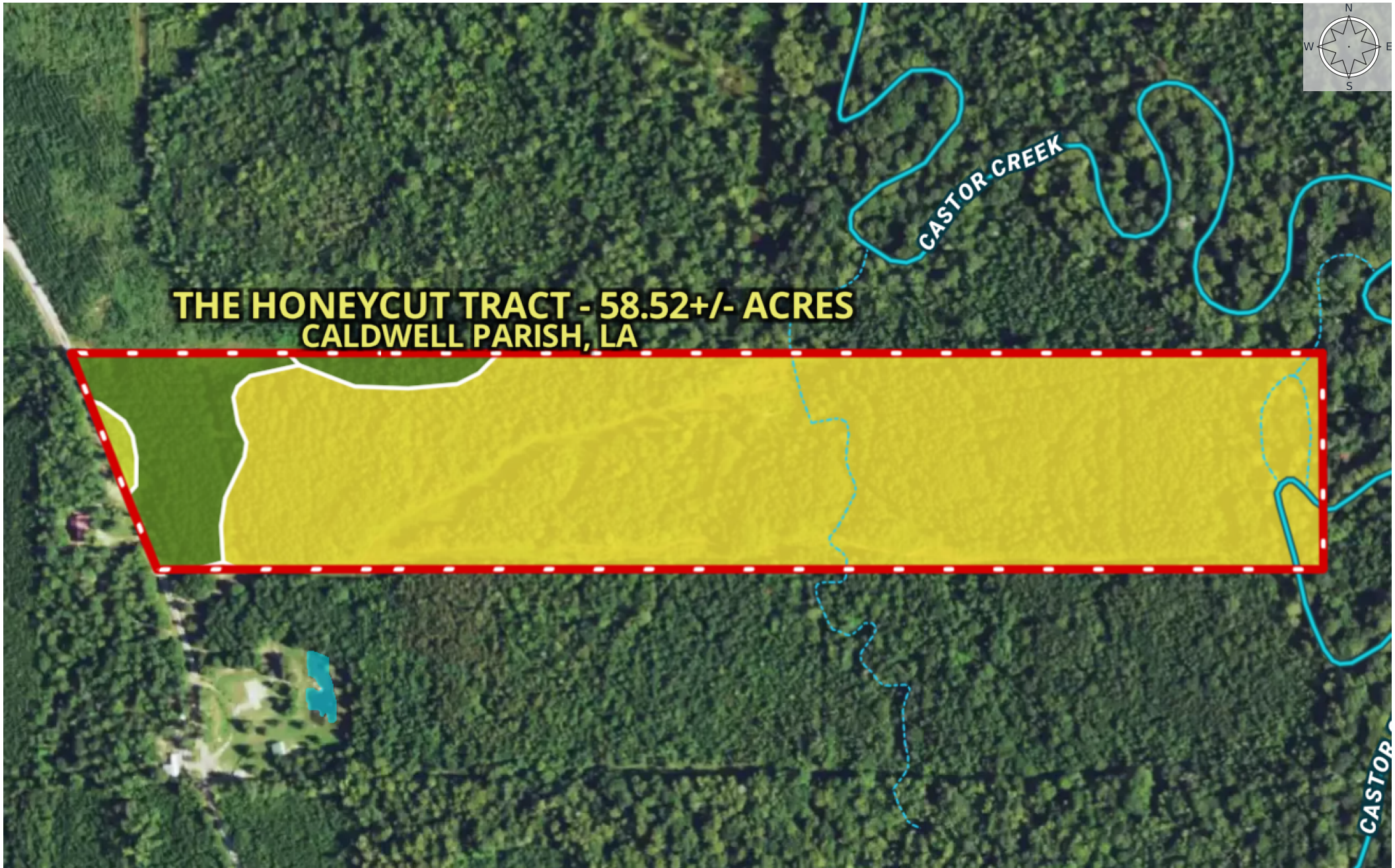

THE HONEYCUT TRACT - 58.52+/- ACRES
CALDWELL PARISH, LA

CASTOR CREEK



- Boundary
- Stream, Intermittent
- River/Creek
- Water Body

|  Boundary 58.51 ac

SOIL CODE	SOIL DESCRIPTION	ACRES	%	CPI	NCCPI	CAP
GY	Guyton and Ouachita silt loams, frequently flooded	51.3	87.66	0	52	5w
FZ	Frizzell-Guyton-Providence association, 0 to 2 percent slopes	5.51	9.42	0	73	2e
Ch	Cahaba fine sandy loam, 1 to 3 percent slopes	1.24	2.12	0	67	2e
SC	Sacul fine sandy loam, moderately sloping	0.46	0.79	0	73	4e
TOTALS		58.51(*)	100%	-	54.45	4.65









(*) Total acres may differ in the second decimal compared to the sum of each acreage soil. This is due to a round error because we only show the acres of each soil with two decimal.

Capability Legend

Increased Limitations and Hazards

Decreased Adaptability and Freedom of Choice Users

Land, Capability

								
	1	2	3	4	5	6	7	8
'Wild Life'	•	•	•	•	•	•	•	•
Forestry	•	•	•	•	•	•	•	
Limited	•	•	•	•	•	•	•	
Moderate	•	•	•	•	•	•		
Intense	•	•	•	•	•			
Limited	•	•	•	•				
Moderate	•	•	•					
Intense	•	•						
Very Intense	•							

Grazing Cultivation

(c) climatic limitations (e) susceptibility to erosion

(s) soil limitations within the rooting zone (w) excess of water